

Features

ECS Protector Dry SMART Vent (U.S. Patents 8,720,591, 9,144,700, 9,186,533 and 9,610,466)

- **Float Valve** - Prevent water discharge if system trips
- **Backpressure Regulator** - Prevent total system depressurization
- **Quick Connect** - Easy installation and servicing
- **Isolation Ball Valve Included**
- **Automatic Shutoff** - No need to come back and close valves

General Description

The ECS Protector Dry SMART Vent provides automatic oxygen venting in dry pipe fire sprinkler systems. As a fire sprinkler system is filled with a continuous supply of nitrogen gas from the ECS AdvancedIQ Nitrogen Generator System, the ECS Protector Dry SMART Vent allows oxygen rich gas to be vented from the fire sprinkler system. Over a short period of time the ECS Protector Dry SMART Vent will almost completely remove oxygen from the fire sprinkler system (<2% oxygen). Once the desired system gas composition is reached the ECS Protector Dry SMART Vent will automatically close and prevent continuous venting.

The ECS Protector Dry SMART Vent must be installed as shown on the engineering design documents. If a location is not specified, install the ECS Protector Dry SMART Vent on the fire sprinkler system riser on the system side of the main control valve. The electric control box must be installed on an adjacent wall near the fire sprinkler system riser.

The ECS Protector Dry SMART Vent is equipped with a levered float valve that allows gas to discharge but prevents liquid water from leaking through the restricted venting orifice in the event that water enters the fire sprinkler system. A back pressure regulator is also included to prevent total system depressurization from the vent assembly before the vent is electronically closed. The restricted venting orifice allows oxygen to be vented from the fire sprinkler system at a controlled rate to achieve a minimum nitrogen concentration of 98%.

The ECS Protector Dry SMART Vent is equipped with an electronic solenoid valve that must be wired to the electric control box (conductors not included). The control box will automatically close the vent once the desired nitrogen concentration has been reached. The control box is equipped with an on/off switch and a vent button to provide a means to restart of the venting process should oxygen be reintroduced into the fire sprinkler system.

Specifications

Dimensions	Vent: 13.5" (W) x 7.5" (H) x 4.25" (D) Control Box: 8" (W) x 10" (H) x 6" (D)
Weight	Vent: 8 Lbs* (3.6 Kg*) Control Box: 10 Lbs (4.5 Kg)
Power Supply	120-240VAC/50-60Hz; <2 Amps
Service Pressure	Up to 175 PSIG (12 Bar)
System Connection	1" NPT Male (25.4mm)
Temperature Range	40°F - 120°F (4.5°C - 49°C)

*Support Hanger Not Required



PSV-D Box

PSV-D

ECS Protector Dry SMART Vent

PSV-D

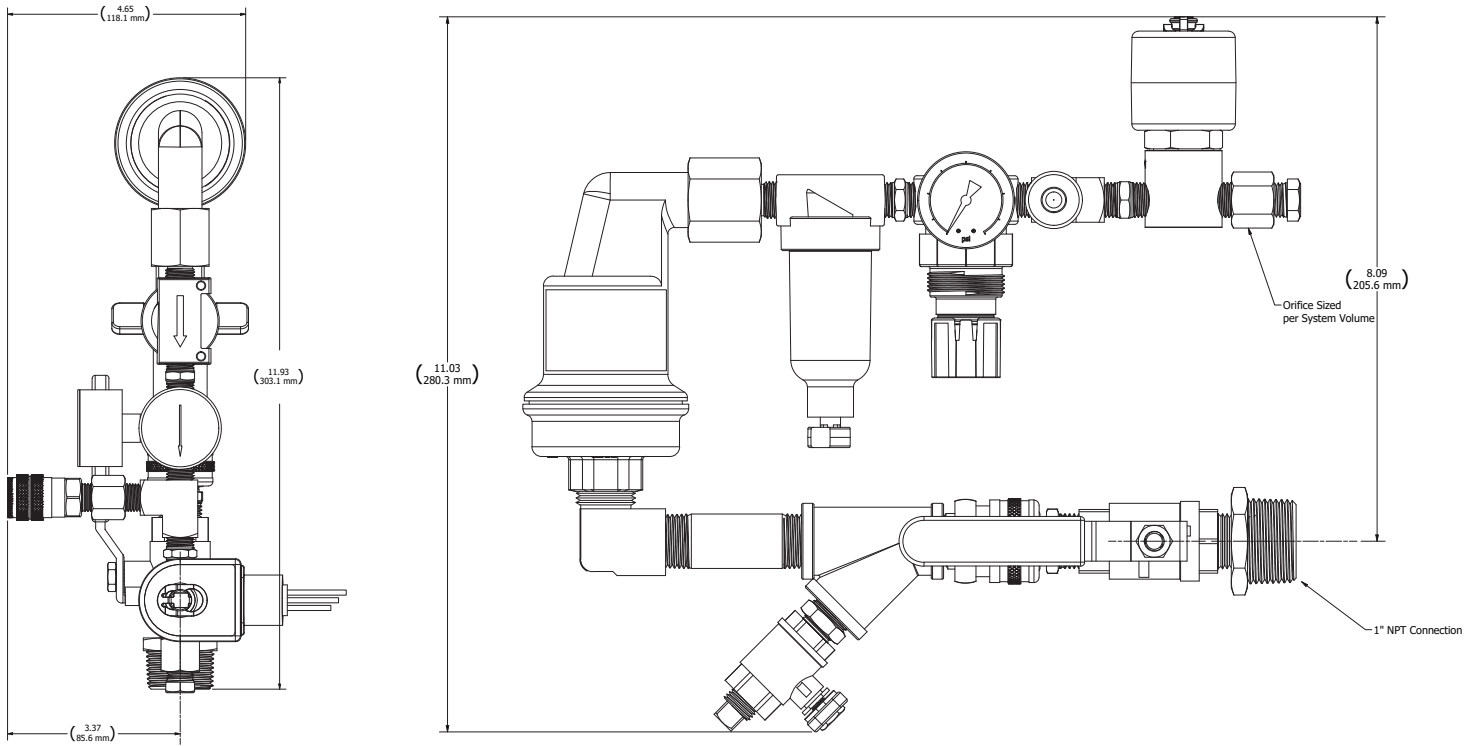

(Dimensions in inches unless otherwise stated.)

PSV-D Box

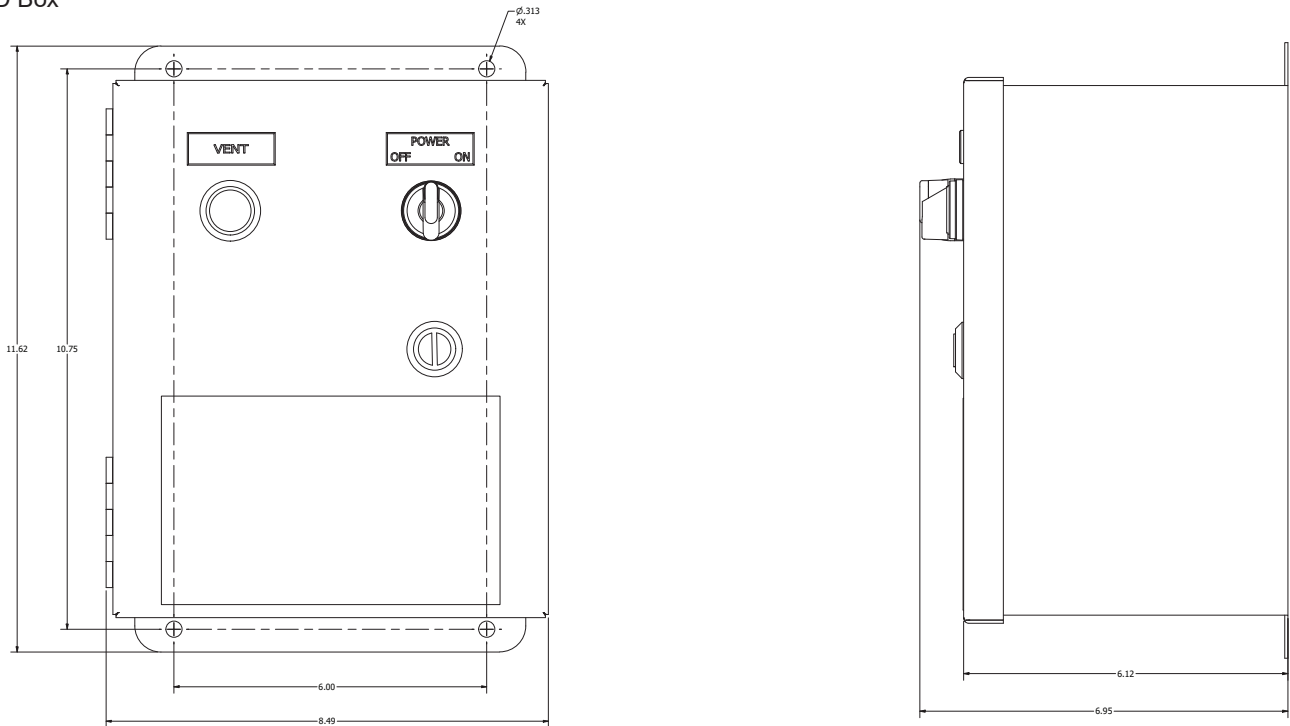

(Dimensions in inches unless otherwise stated.)